

DBA

Chave de código / How to order

DBA (F) - (15)

Número de contatos / Number of contacts
15, 26

M - Macho / Male
F - Fêmea / Female

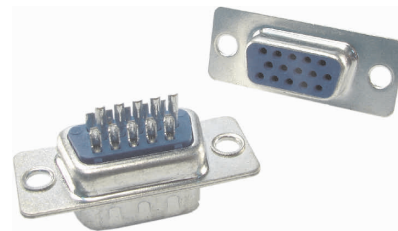

Especificações / Specifications

Corrente máxima / Current rating	3 A
Resistência de contato máx. / Maximum contact resistance	30 m
Resistência de isolamento mín. / Minimum insulation resistance	1000 M (500 VCC / VDC)
Rigidez dielétrica / Withstanding voltage	1000 VCA / VAC (1 minuto / minute)
Temperatura de operação / Operate temperature range	-55°C a (to) +105°C
Material do isolador / Insulator material	PBT UL94V-0
Material dos contatos / Contact material	Latão dourado / Gold brass
Terminais / Terminals	Latão estanhado / Brass tin finished
Cor do dielétrico / Dielectric color	Azul / Blue

Fêmea

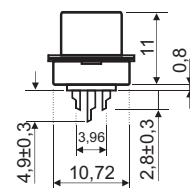
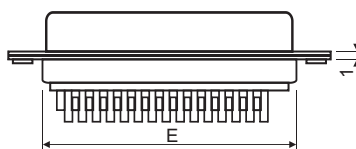
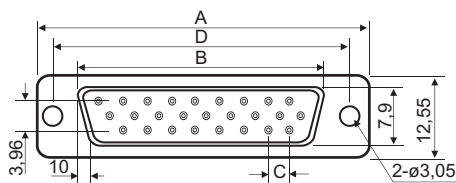

Macho

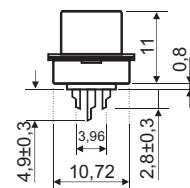
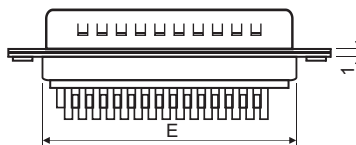
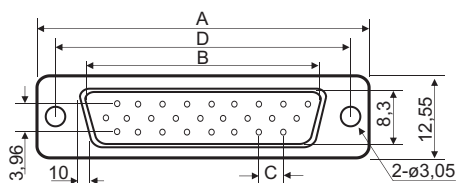

No de contatos No of contacts	A	B		C	D	E
		Macho / Male	Fêmea / Female			
15	30,8	16,9	16,2	2,29	24,99	19,3
26	39,1	25,3	24,6	2,29	33,32	27,5